



## Common Mode Choke Size 1678

采用紧凑均匀的绕线工艺，有效减低寄生电容，提高线间耐压等级  
标称额定电压250Vac; 线间绝缘测试电压1500Vac  
工作温度范围：-55 ~+125

电源线输入、输出共模噪声消减和浪涌抑制（250Vac）  
电力电源装置的浪涌抑制和EMI滤波  
浮地装置的滤波  
EMI对策用  
特别适用于AC/DC转换，DC/AC逆变等线路的电磁干扰抑制

Dimensions: [mm]

Land Pattern: [mm]

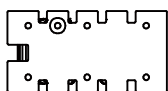

Schematic:

Irms Derating Characteristics:

Construction:

Wire Type:

Ambient temperature(

## Electrical Properties:

	L( $\mu$ H) $\pm$ 30%	(A)	max (m )				
CMC1678-140N		4.0		1500	250	NiZn	10kHz/0.25V
CMC1678-300N	30	3.0	26	1500	250	NiZn	10kHz/0.25V
CMC1678-470N		2.0	40	1500	250	NiZn	10kHz/0.25V
CMC1678-101N	100		80	1500	250	NiZn	10kHz/0.25V
CMC1678-102N	1,000	2.0		1500	250	MnZn	10kHz/0.25V
CMC1678-402N	4,000		140	1500	250	MnZn	10kHz/0.25V
CMC1678-502N	5,000	1.0	220	1500	250	MnZn	10kHz/0.25V
CMC1678-103N	10,000	0.7	350	1500	250	MnZn	10kHz/0.25V
CMC1678-203N	20,000	0.5	1000	1500	250	MnZn	10kHz/0.25V
CMC1678-393N	39,000	0.3	3000	1500	250	MnZn	10kHz/0.25V

## Typical Electrical Characteristics:

### Insertion Loss Common Mode

